

RODIN

FZERO

NO LIMITS.



RODIN
C A R S

FZERO

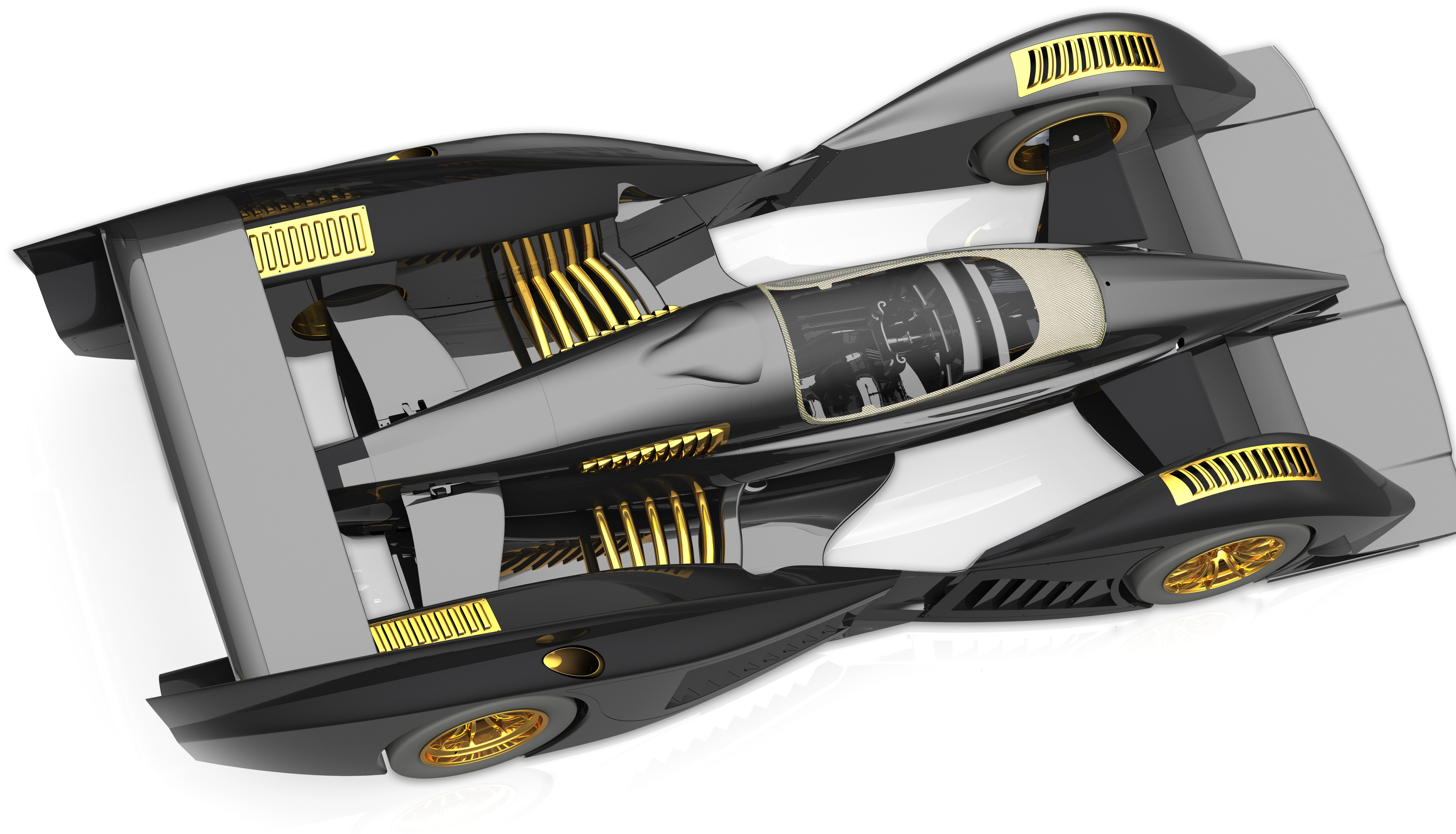

NO LIMITS.

RODIN
C A R S

CHASSIS, WEIGHT & DIMENSIONS



CHASSIS CONSTRUCTION Carbon Fibre Composite (main body section from nose to tail)

WEIGHT

698kg

DIMENSIONS

Length 5500 mm

Width 2200 mm

Height 1130 mm

Track, Front 1852 mm

Track, Rear 1790 mm

Wheel Base 3000 mm

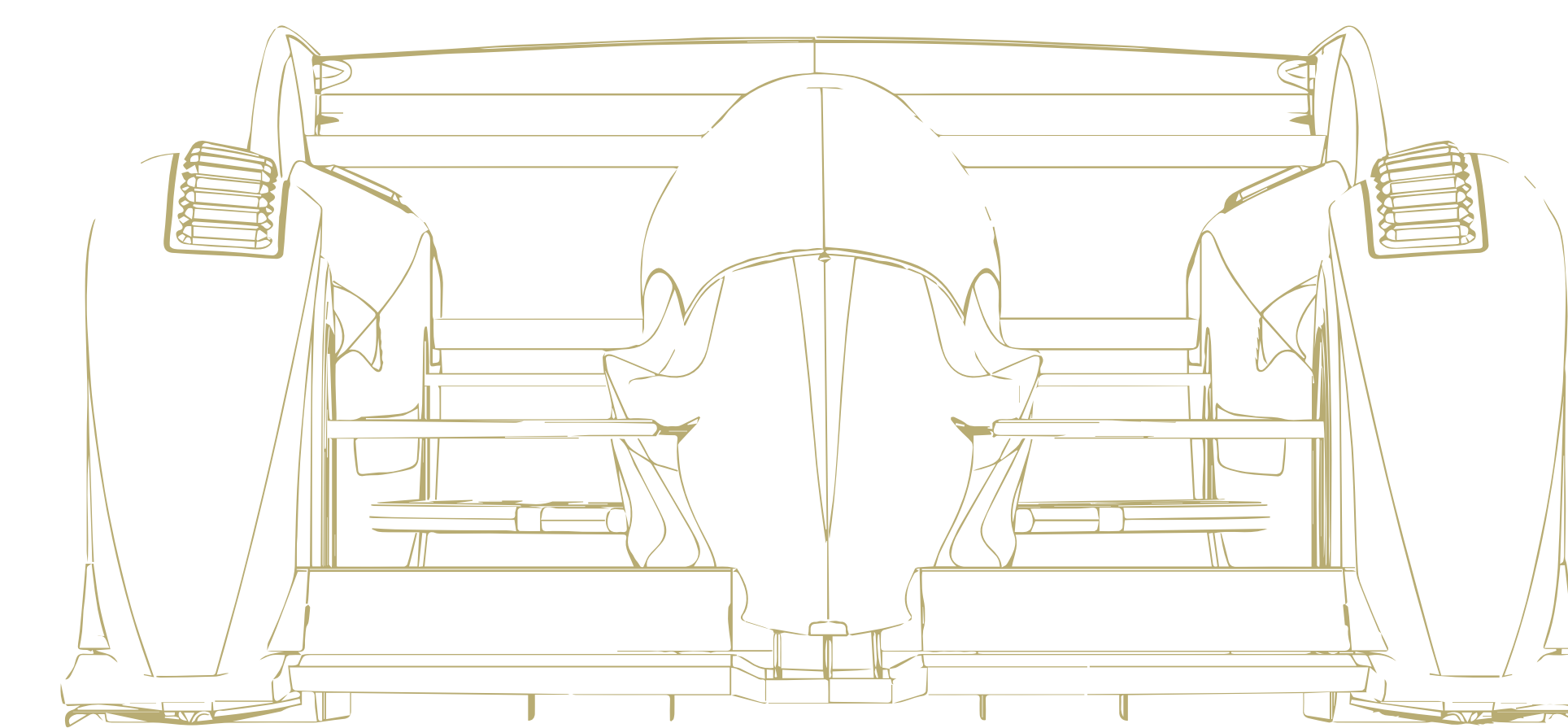
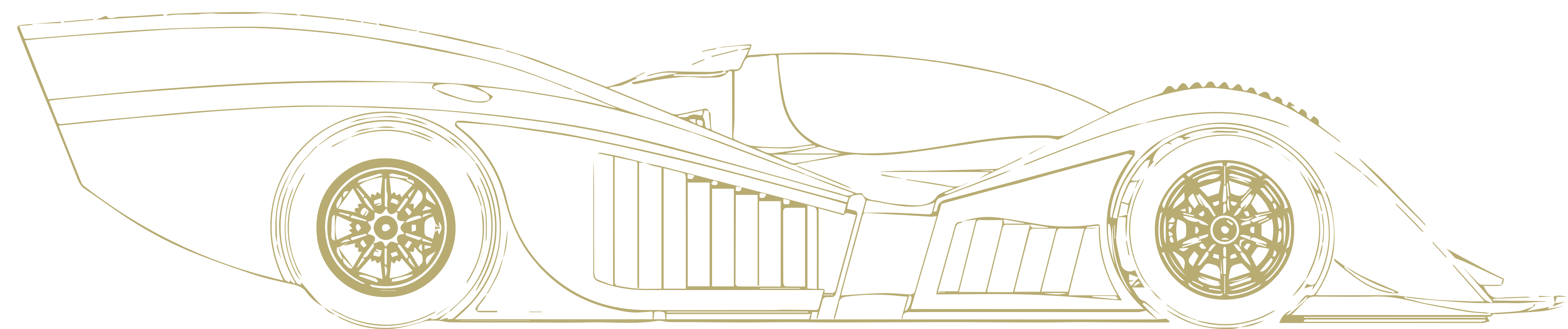

NO LIMITS.

ENGINE SPECIFICATIONS



<i>TYPE</i>	Twin turbo hybrid v10 with additional Electric Motor
<i>ENGINE PHILOSOPHY</i>	Designed to be the lightest and most compact V10 created
<i>ENGINE NAME</i>	RCTEN
<i>DISPLACEMENT (cc)</i>	4,000cc (not created to be bored to 4.5L or 5.0L)
<i>MAX ENGINE POWER (PS) @ rpm</i>	1000 @ 9000 rpm
<i>MAX ENGINE TORQUE (Nm) @ rpm</i>	910 @ 7250 rpm
<i>MAX COMBINED POWER (PS)</i>	1176
<i>MAX COMBINED TORQUE (Nm)</i>	1026
<i>MAX ENGINE SPEED (rpm)</i>	10,000 rpm
<i>BORE (mm) x STROKE (mm)</i>	86 mm x 68.8 mm
<i>COMPRESSION RATIO</i>	10 : 1
<i>FUEL INJECTION</i>	Direct (Bosch) running at 200 bar
<i>THROTTLE</i>	Bosch drive-by-wire
<i>OVERALL UNIT WEIGHT (kg's)</i>	132 kg (not including intake and exhaust systems)

NO LIMITS.

ENGINE LAYOUT

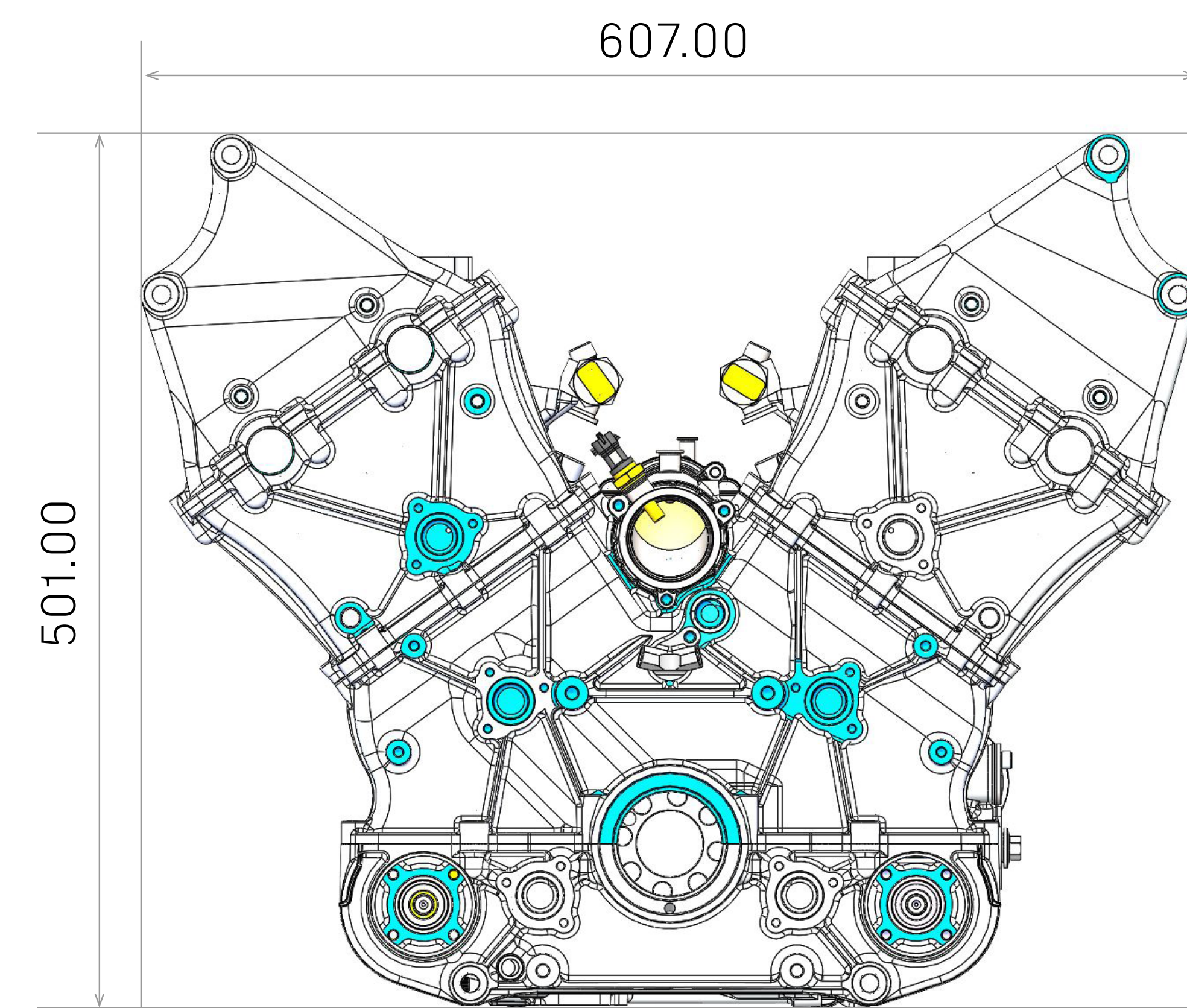

FRONT PROFILE

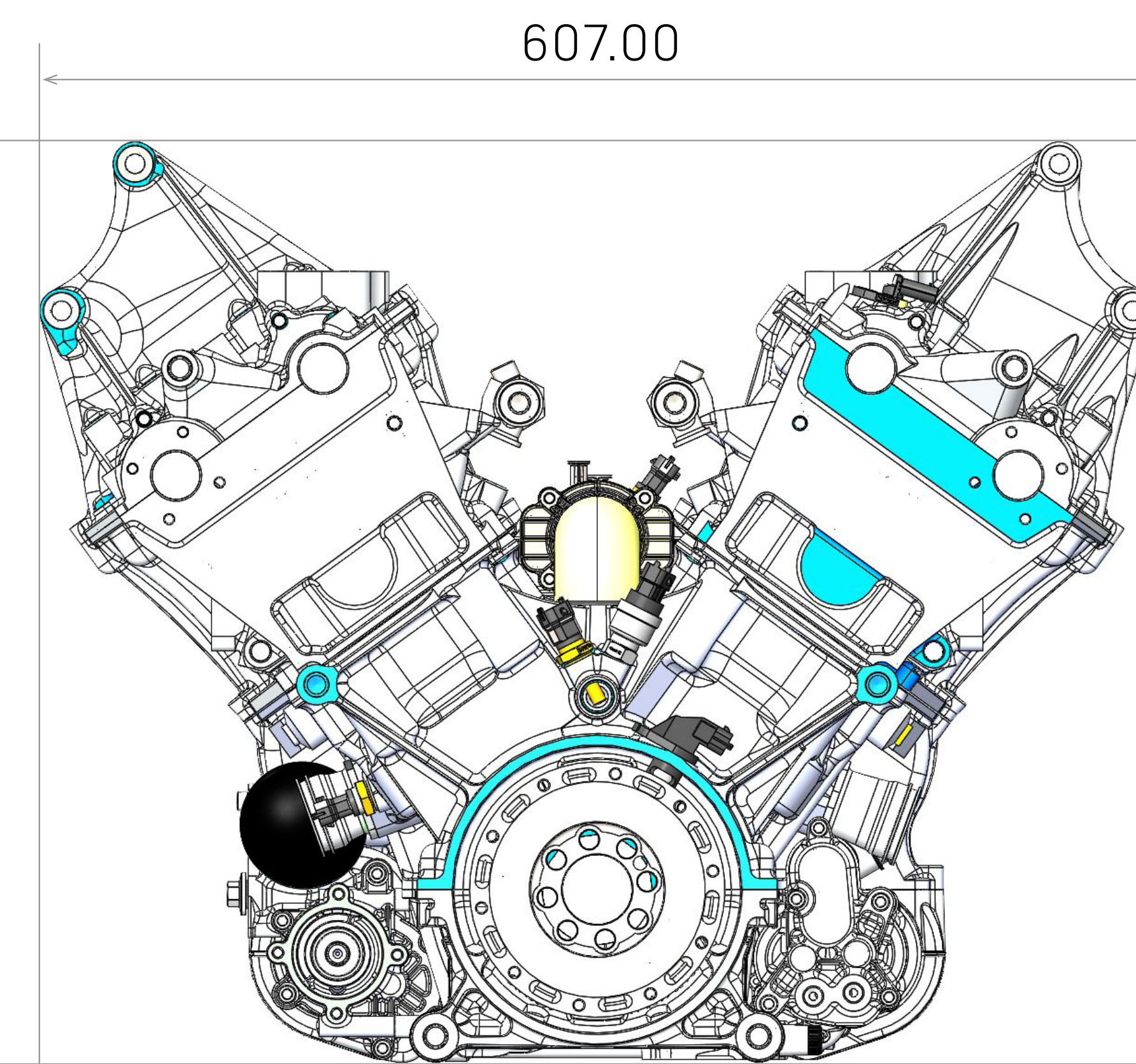

REAR PROFILE

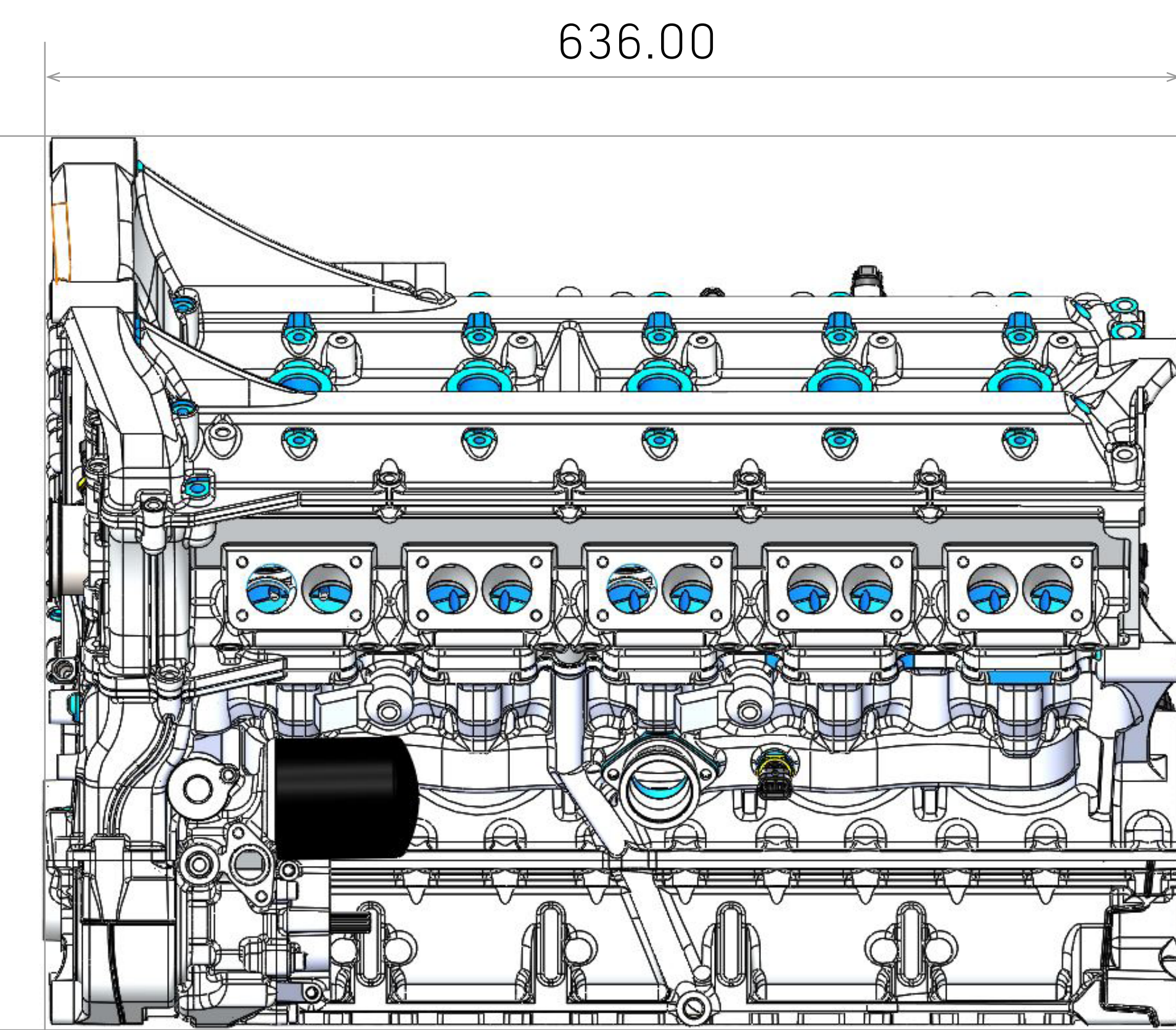

SIDE PROFILE

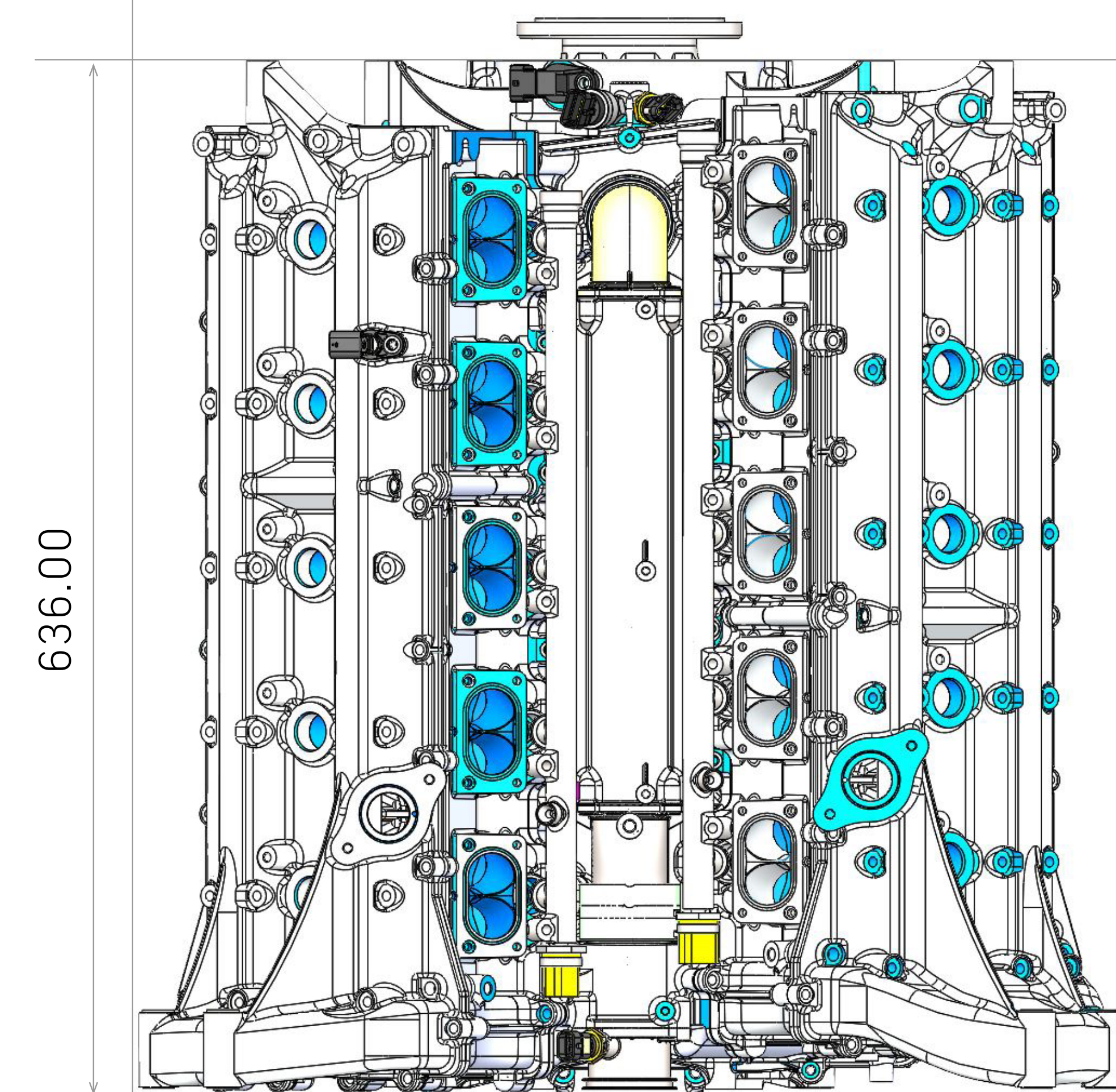

TOP PROFILE

RODIN *RCTEN*

- Bespoke V10 designed and manufactured for our chassis and power requirements
- 4.0L twin turbo, 72 degree bank angle

NO LIMITS.

CRANKSHAFT

FZERO

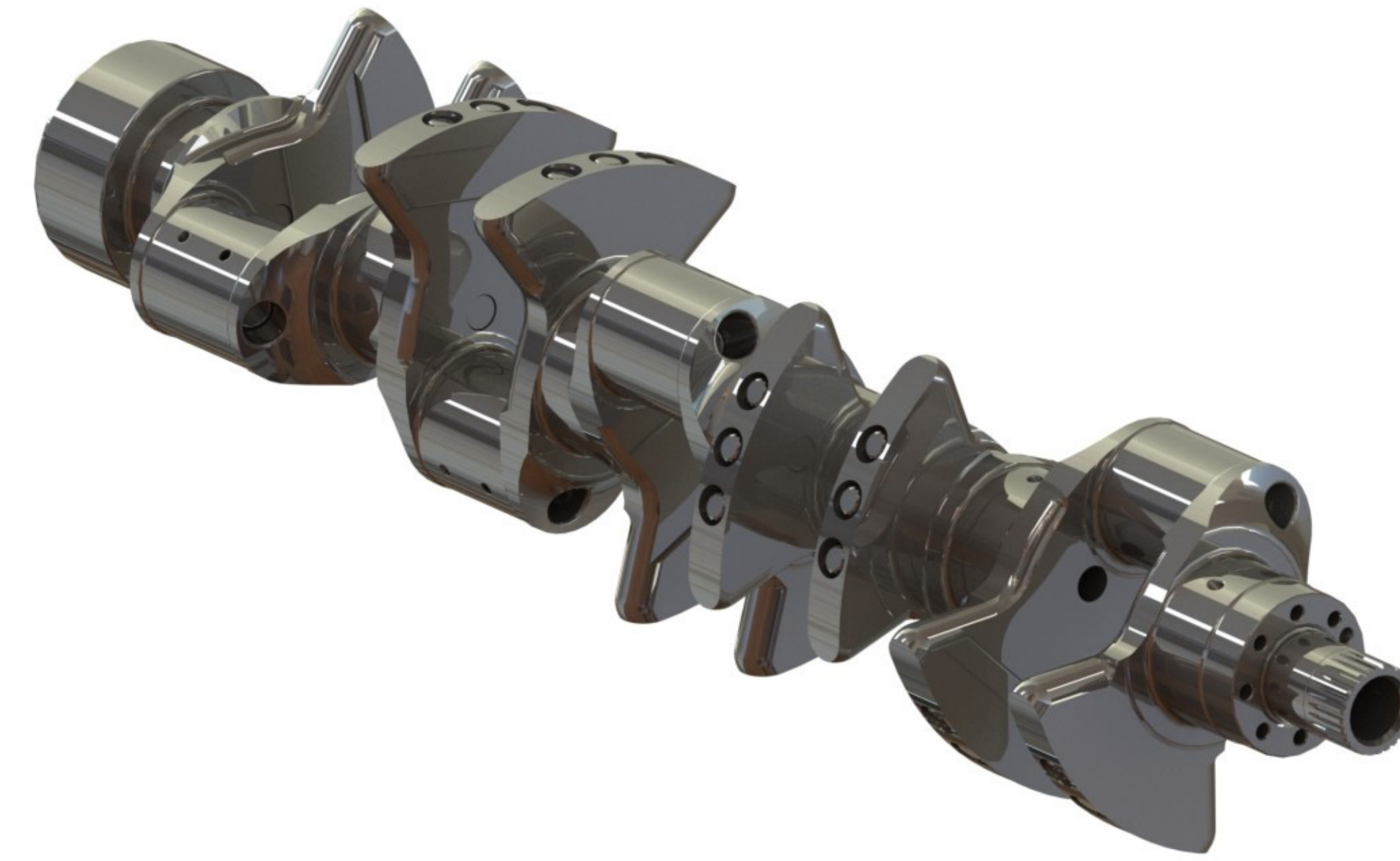

- Machined from high strength steel billet to F1 standards

OIL PUMPS

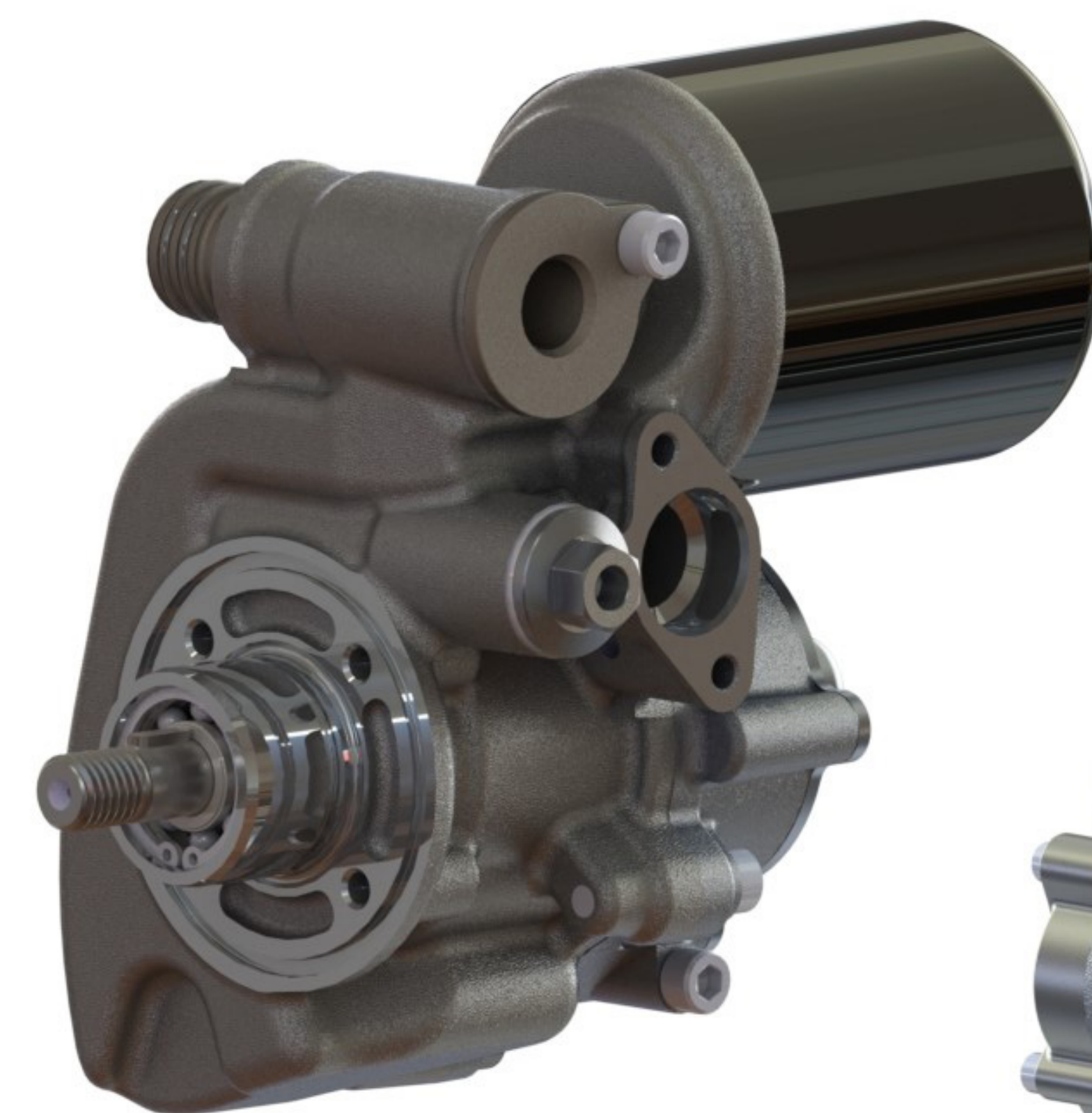

PRESSURE PUMP



SCAVENGE PUMP

VALVETRAIN



NO LIMITS.

RODIN
CARS

HYBRID SYSTEM / ELECTRIC MOTOR

FZERO

POWER 130kW

- Custom hybrid motor manufactured in conjunction with Integral Powertrain
- 4 purposes (starter, alternator, boost and regeneration)
- Custom high voltage battery (very compact with high power output)

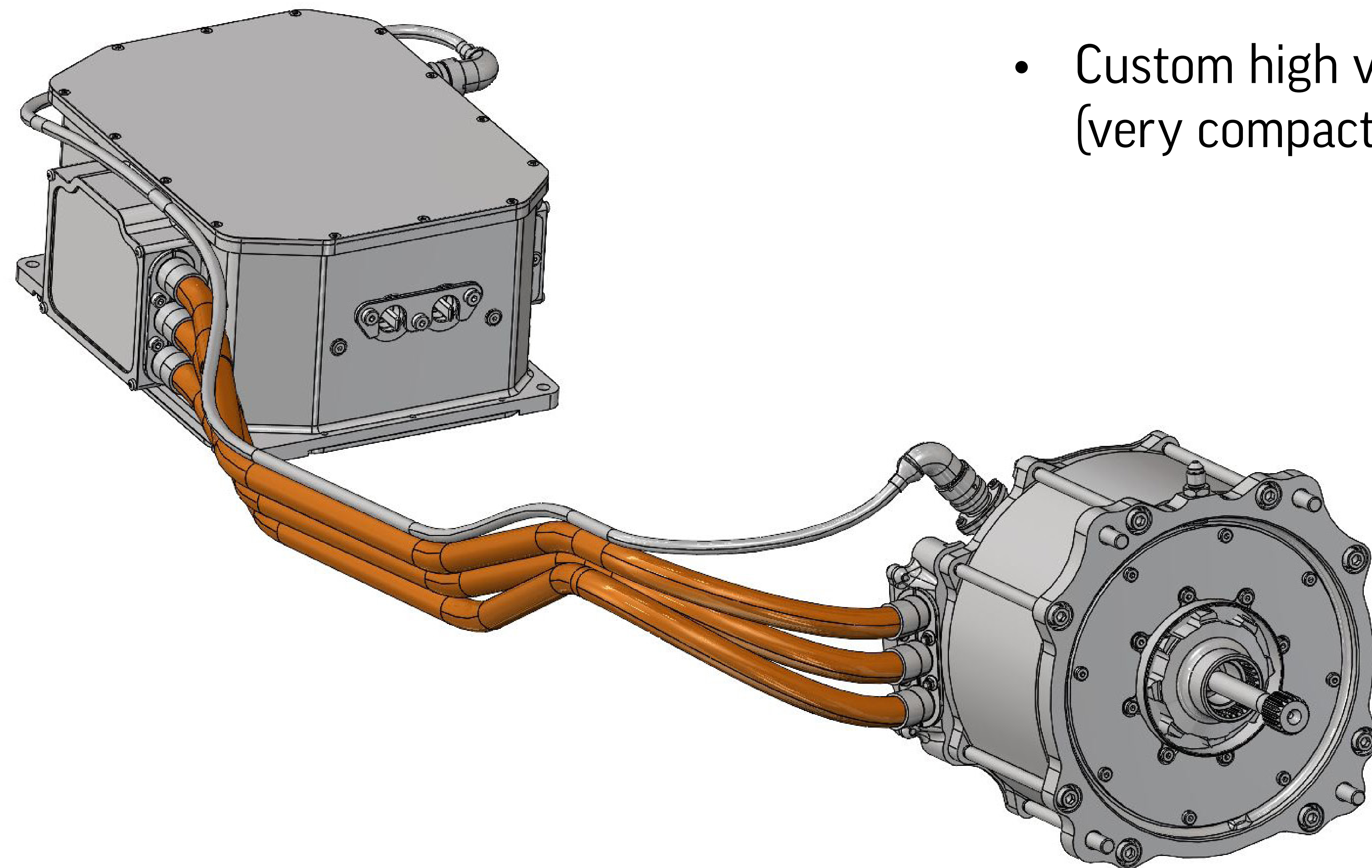

NO LIMITS.

RODIN
C A R S

INTAKE MANIFOLD

FZERO

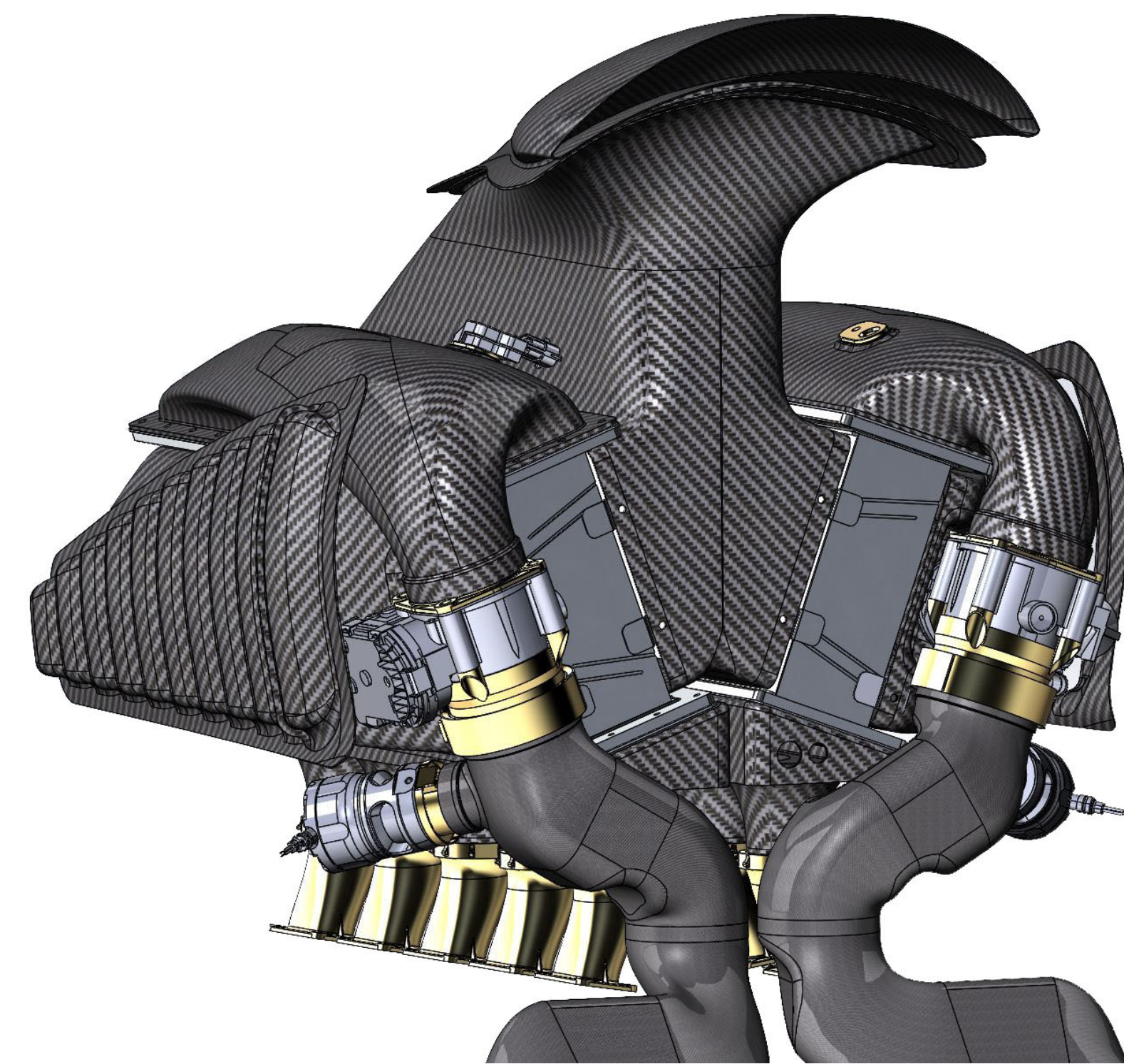

- Compact intercooled twin turbocharged system with integrated electronic wastegates
- Titanium 3D printed manifolds with carbon fibre composite charge pipes and plenums
- Individual, titanium runners with intercoolers mounted above the runners

EXHAUST



- Lightweight 9.4kg including manifolds and up pipes (not including turbos or wastegates)

NO LIMITS.

RODIN
C A R S

TRANSMISSION & DRIVETRAIN



GEARBOX Bespoke unit manufactured in conjunction with Ricardo UK
Titanium 3D printed case, electric MEGA-Line gear shifter

NUMBER OF GEARS 8

OVERALL WEIGHT 65.85kgs

DIFFERENTIAL Computer Controlled, Hydraulic

GEAR RATIO CHART

GEAR	RATIO
1 st	2.846
2 nd	2.188
3 rd	1.684
4 th	1.450
5 th	1.273
6 th	1.160
7 th	1.074
8 th	1.000

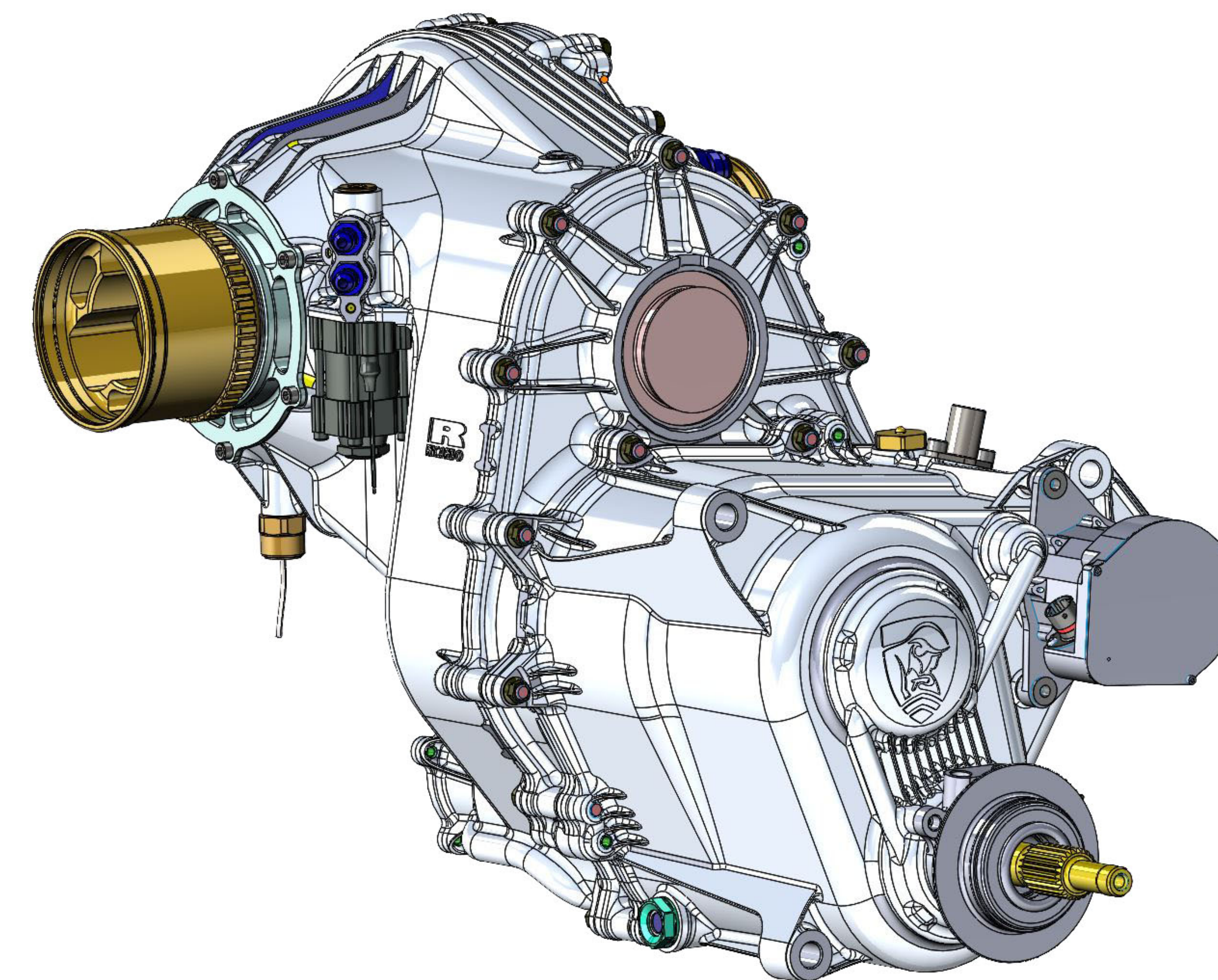

NO LIMITS.

ENGINE & AUXILIARIES



ENGINE ASSEMBLY - ABOVE COMPLETE

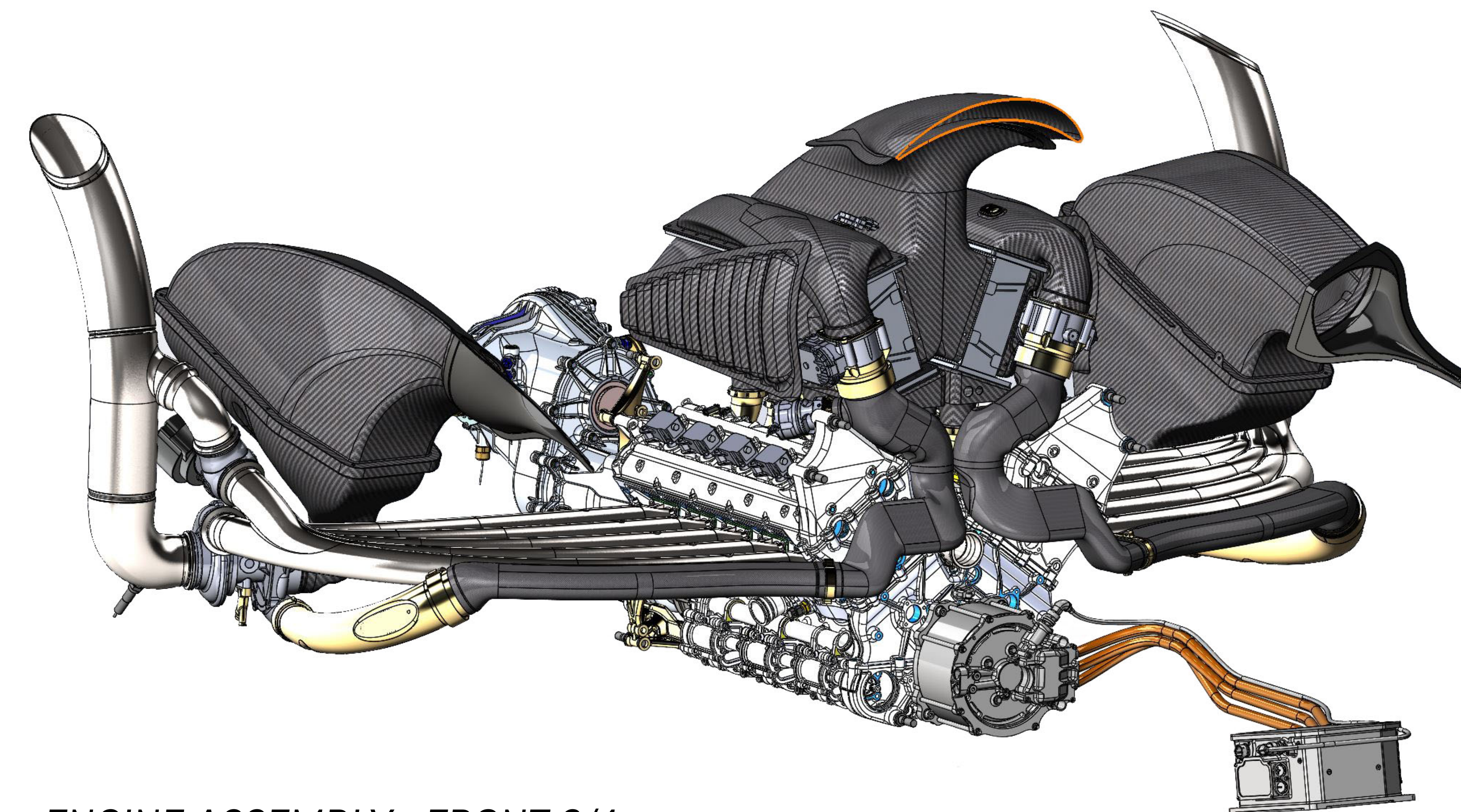
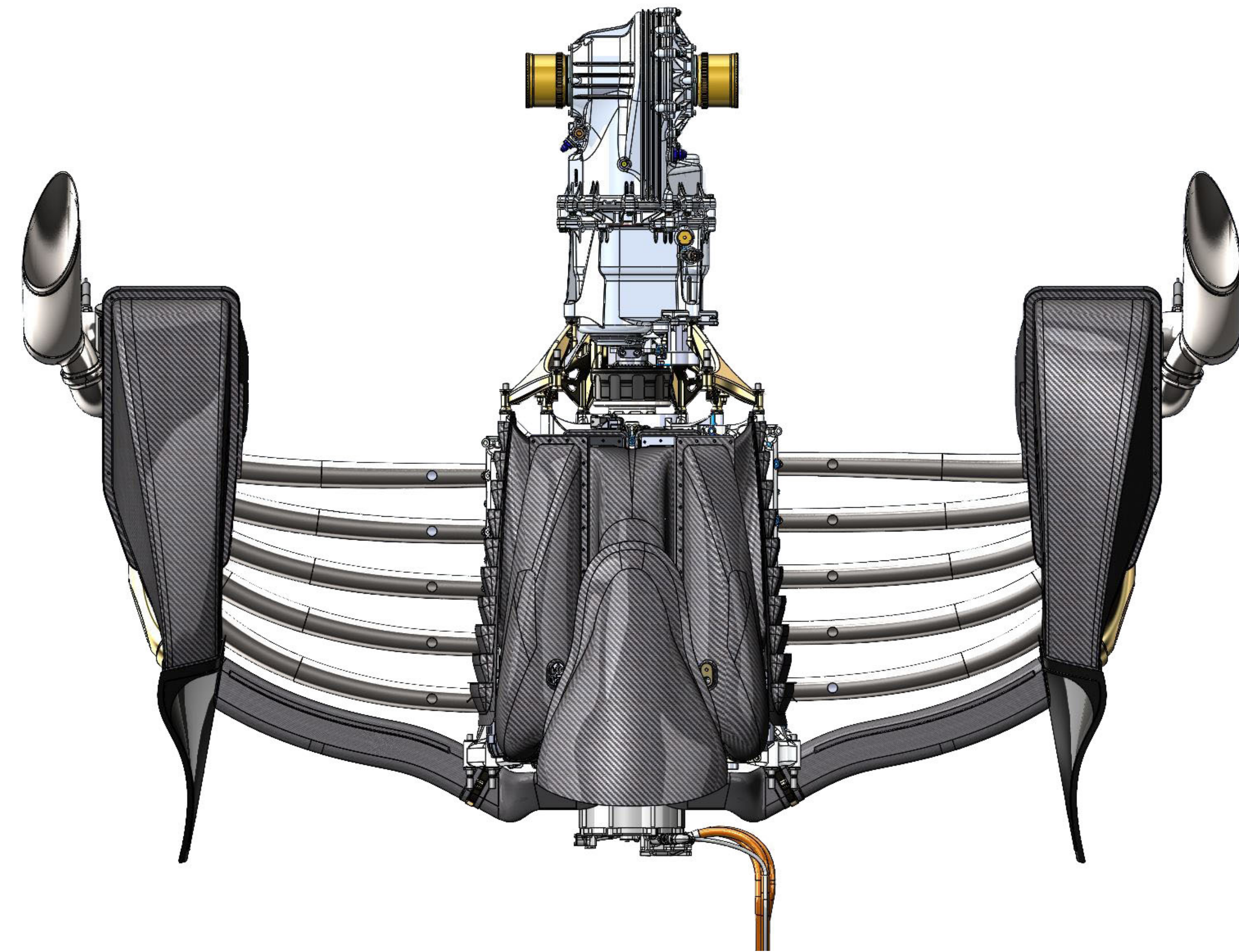

ENGINE ASSEMBLY - FRONT 3/4

NO LIMITS.

BRAKES & BRAKING SYSTEMS



<i>FRONT BRAKES</i>	380mm PFC Carbon-Carbon, Titanium 6 Piston Calipers
<i>REAR BRAKES</i>	380mm PFC Carbon-Carbon, Titanium 4 Piston Calipers
<i>ANTI-LOCK BRAKING SYSTEM (ABS)</i>	Yes
<i>TRACTION CONTROL SYSTEM (TCS)</i>	Yes
<i>ADDITIONAL</i>	Regenerative braking from hybrid system
<i>UPRIGHTS</i>	Titanium 3D printed uprights and hubs with carbon-carbon rotors and active controllable cooling

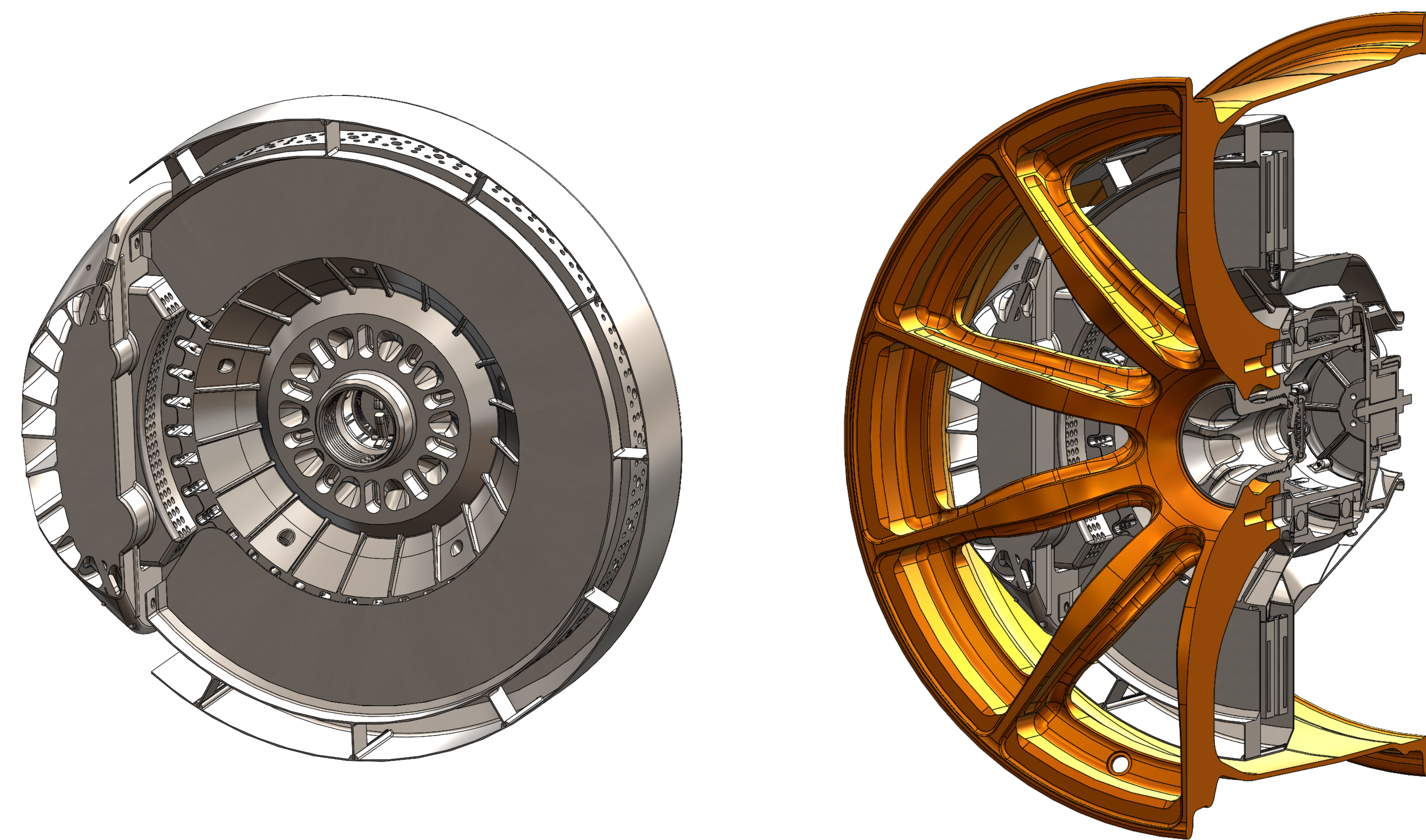

NO LIMITS.

WHEELS & TYRES

FZERO

WHEELS Bespoke 18" forged magnesium rims manufactured in conjunction with OZ Racing
Produced to F1 standard.

RIM SIZE, FRONT 18" x 14"

RIM SIZE, REAR 18" x 16"

TYRES Supplied by Avon

TYRE WIDTH, FRONT 300 / 705 / 18

TYRE WIDTH, REAR 360 / 720 / 18

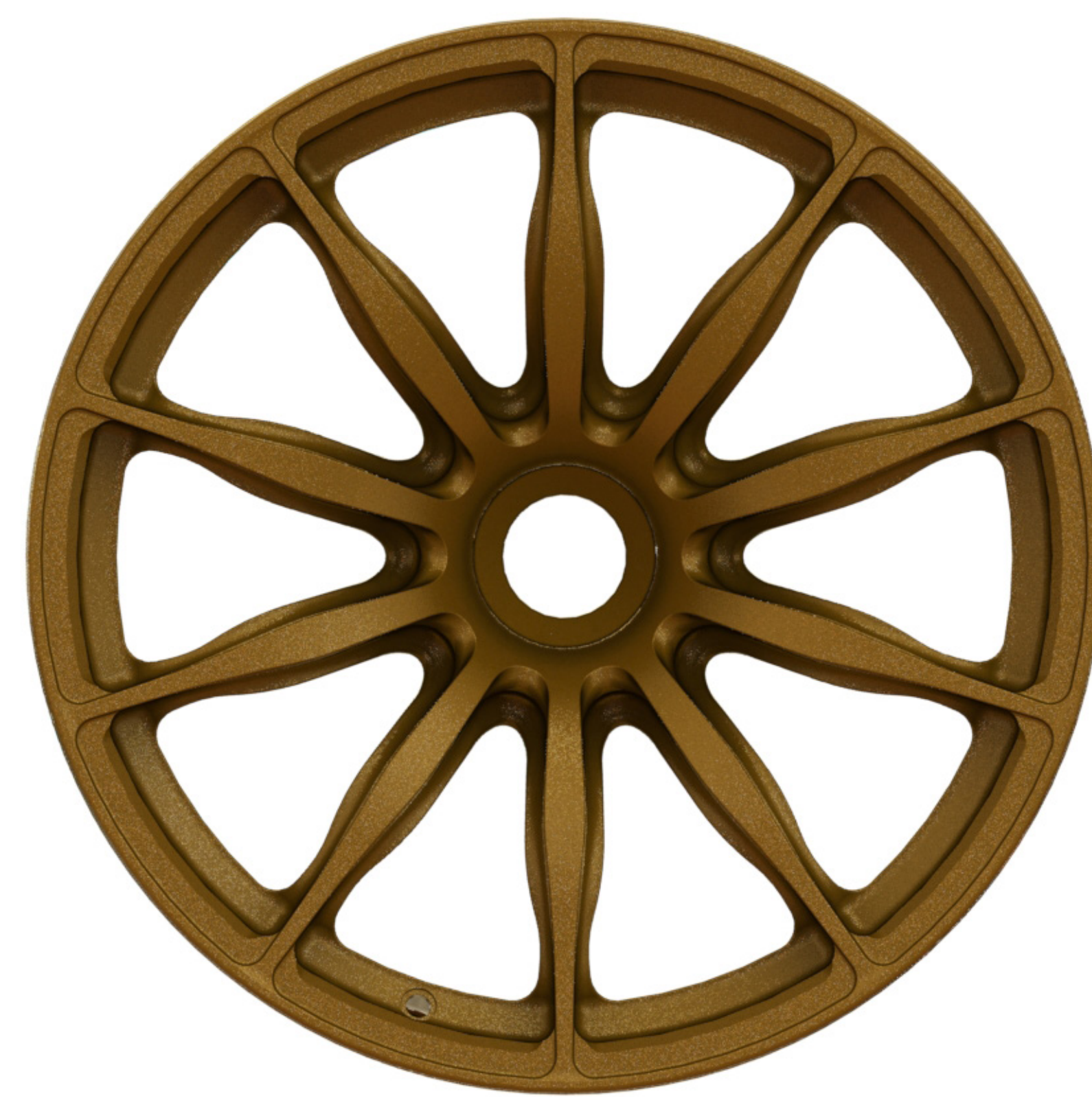

FRONT WHEEL

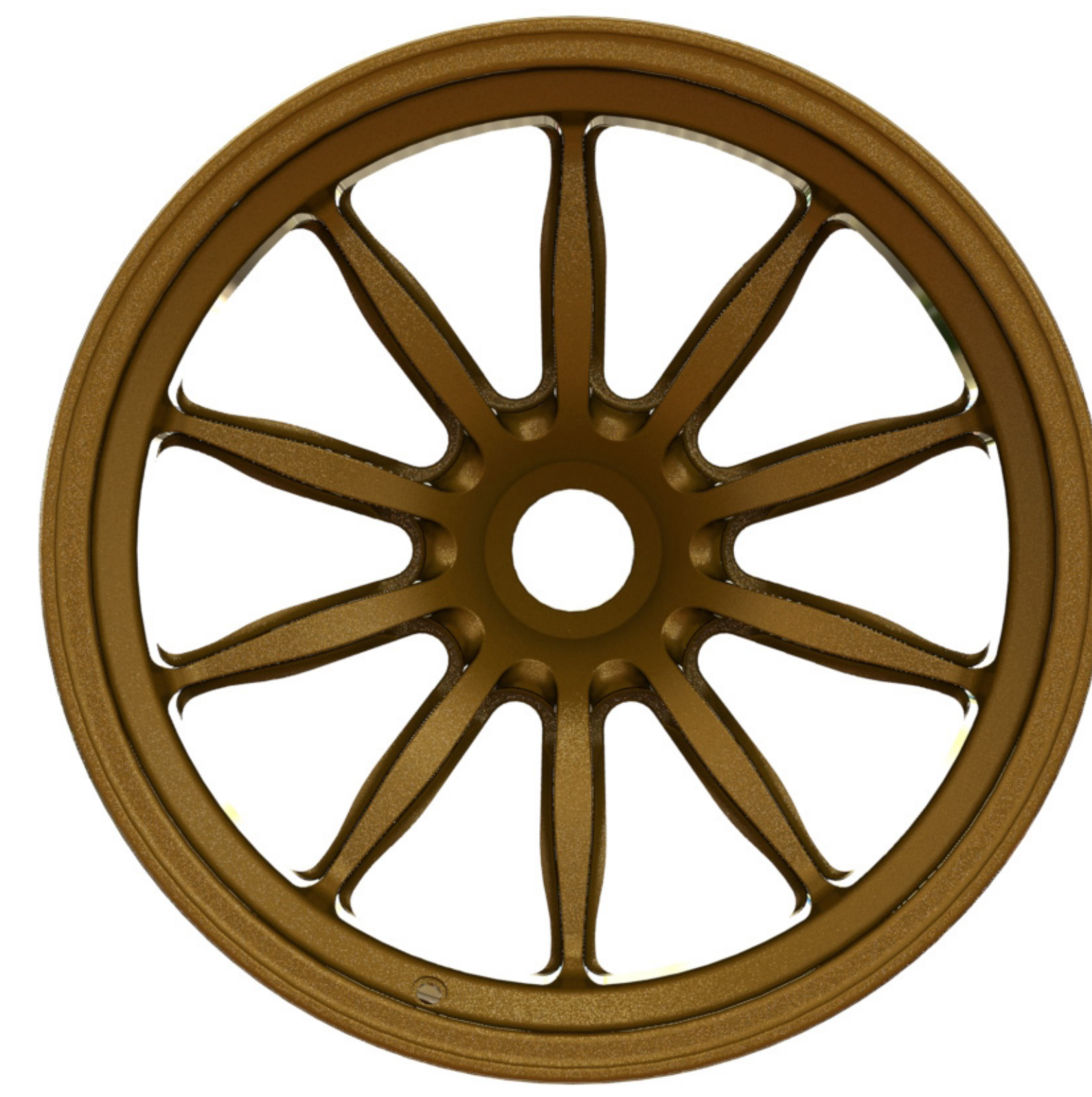

REAR WHEEL



REAR WHEEL

NO LIMITS.

RODIN
CARS

PERFORMANCE

FZERO

TOP SPEED

360 km/h *(subject to aero configuration)*



NO LIMITS.

RODIN
C A R S